

BYOM

BYOD

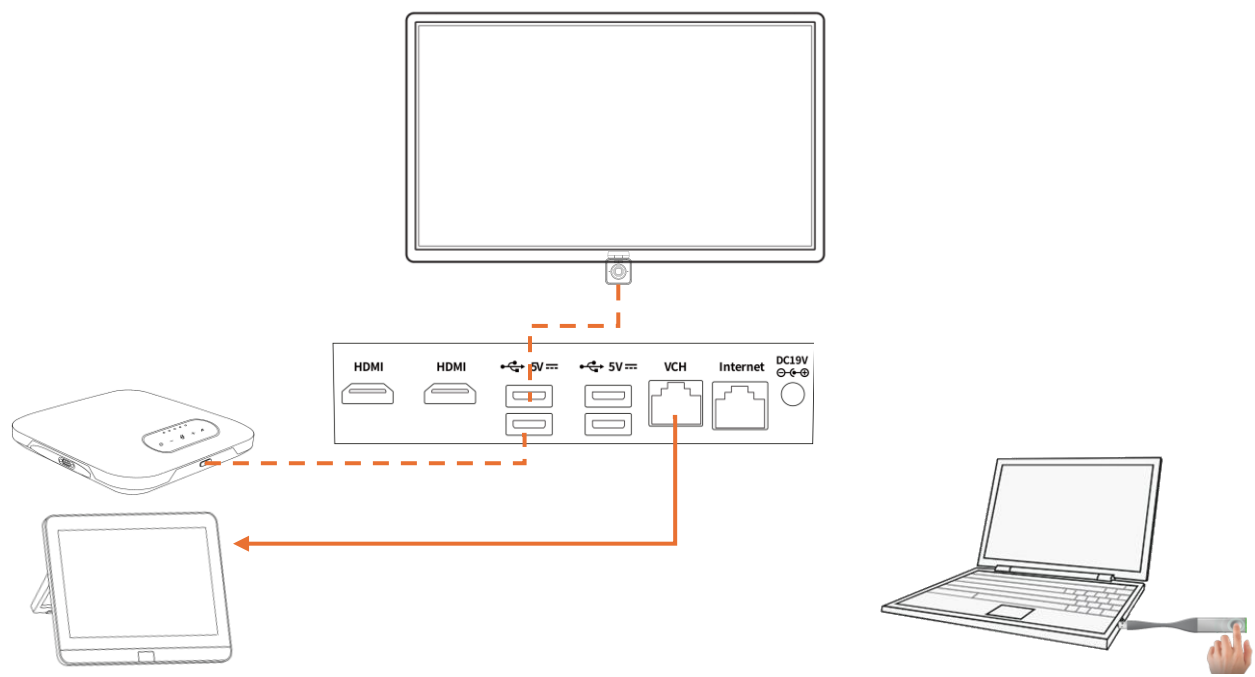

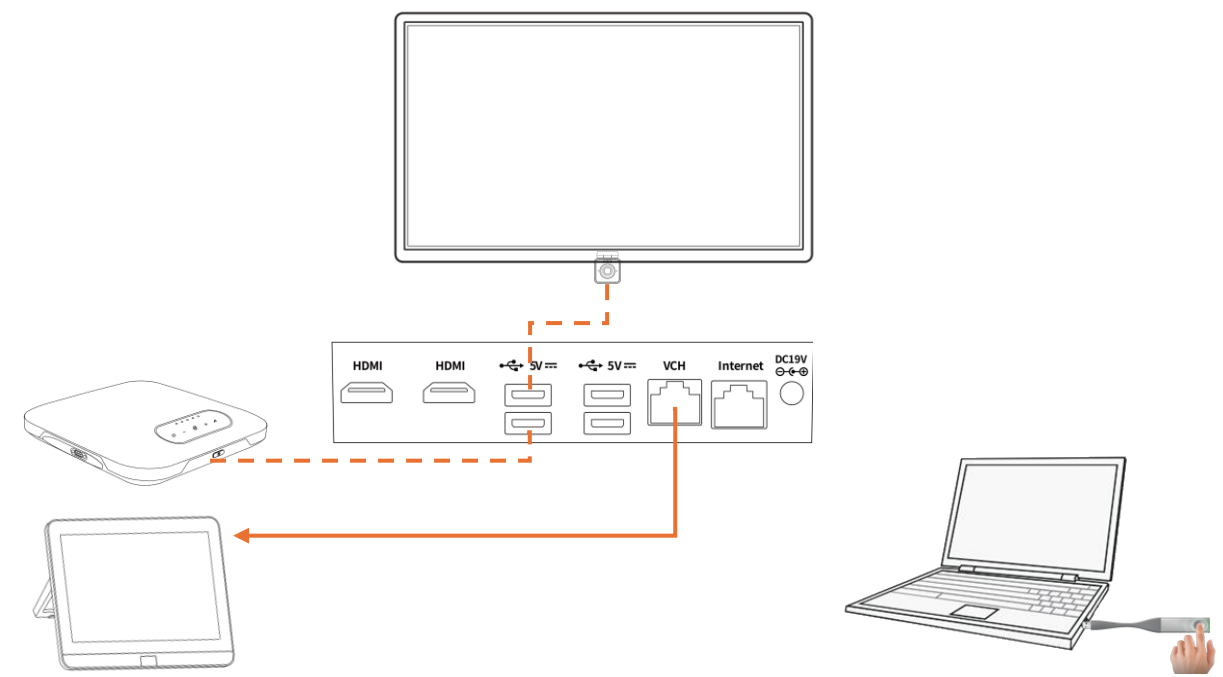
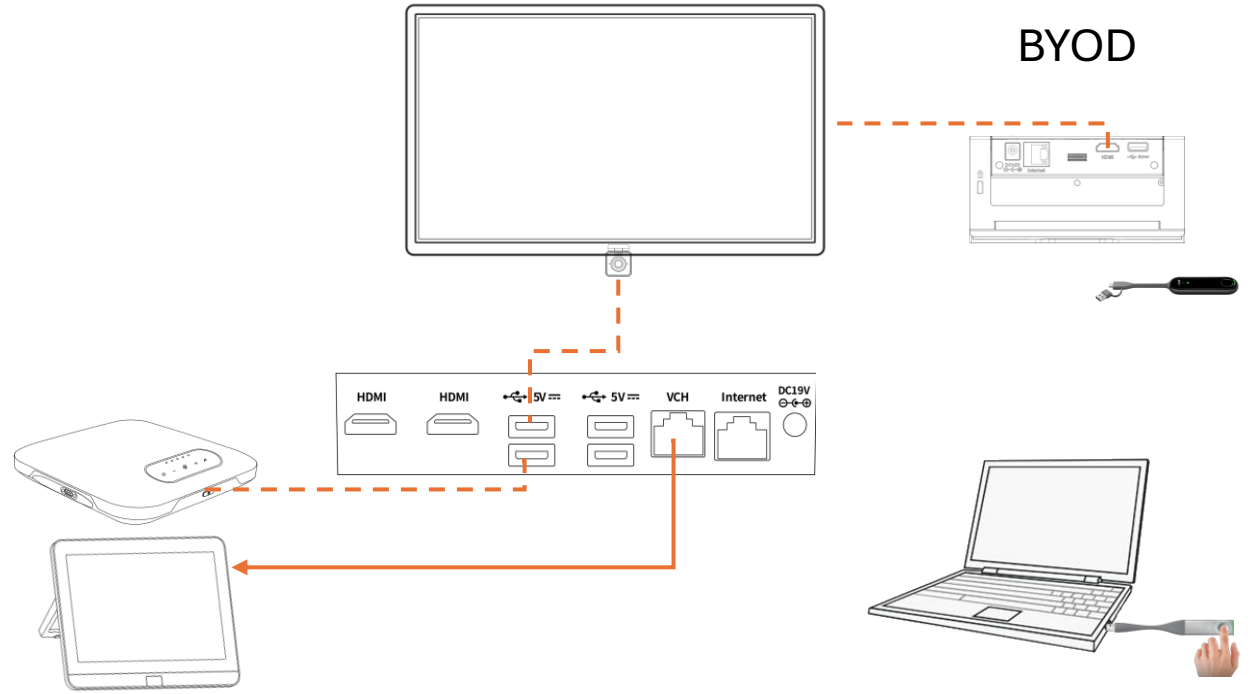
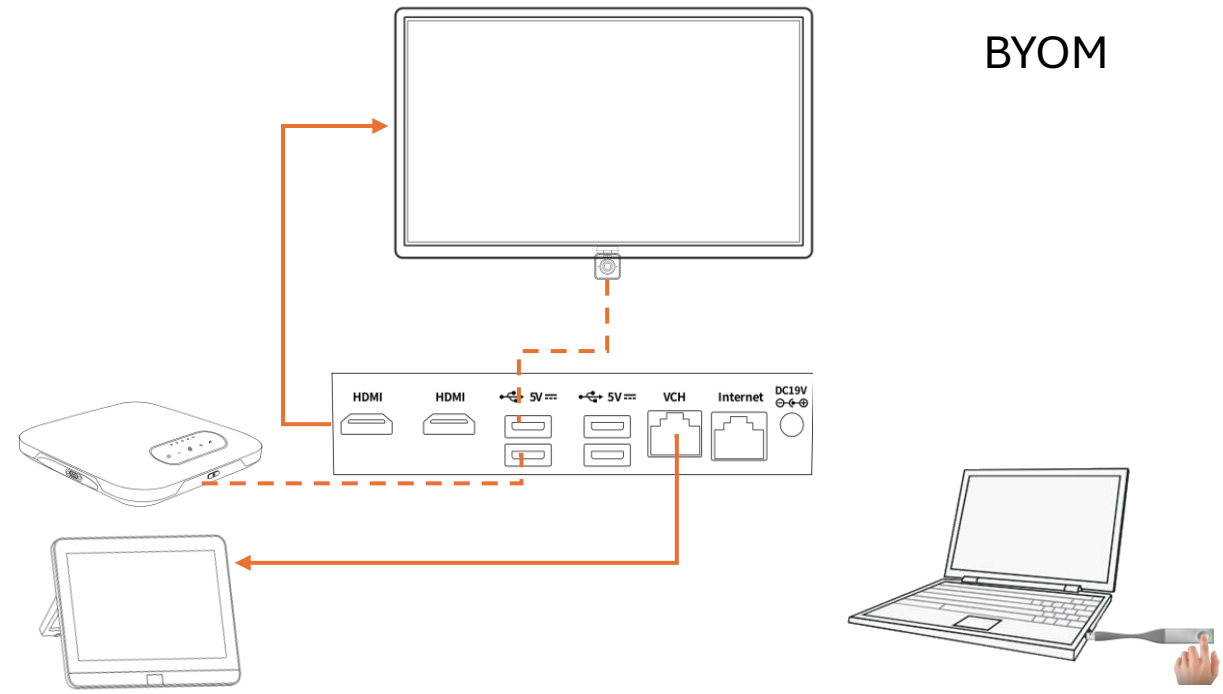

connect USB dongle
wireless keyboard mouse

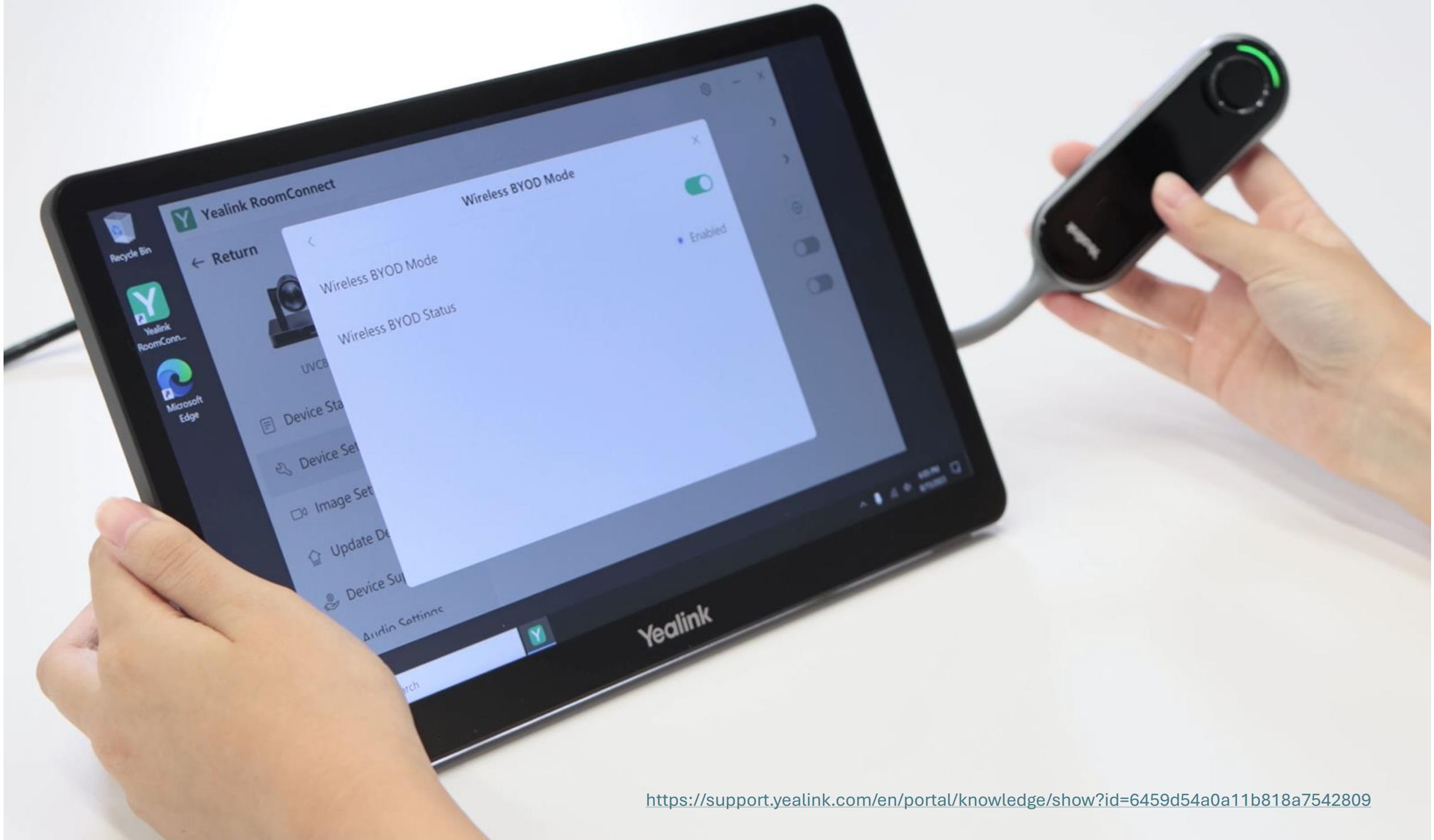

1. Pair WPP with Touch Panel

Pair WPP20 with MTouch II

Connect WPP20 to the USB port of MTouch II for pairing, and wait for more than 3 seconds until the WPP20 LED indicator turns solid green.



WPP20

Accessories

Last Update Time: 2023-07-18

Pageviews: 4012

<https://support.yealink.com/en/portal/knowledge/show?id=64b64c2c5b323b55e7a98572>

- [AVHub Installation](#)
- [MCore Installation](#)
- [MCore Pro Installation](#)
- [MCore Lite Installation](#)
- [MTouch E2 Installation](#)
- [MTouch Plus Installation](#)
- [MSpeech Installation](#)
- [MVC BYOD-Extender Installation](#)
- [RCH40 Installation](#)
- [USB Connector Installation](#)
- [BYOD Box Installation](#)
- [USB Extender Installation](#)
- [SmartVision 60 Installation](#)
- [MTouchPlus-EXT Installation](#)

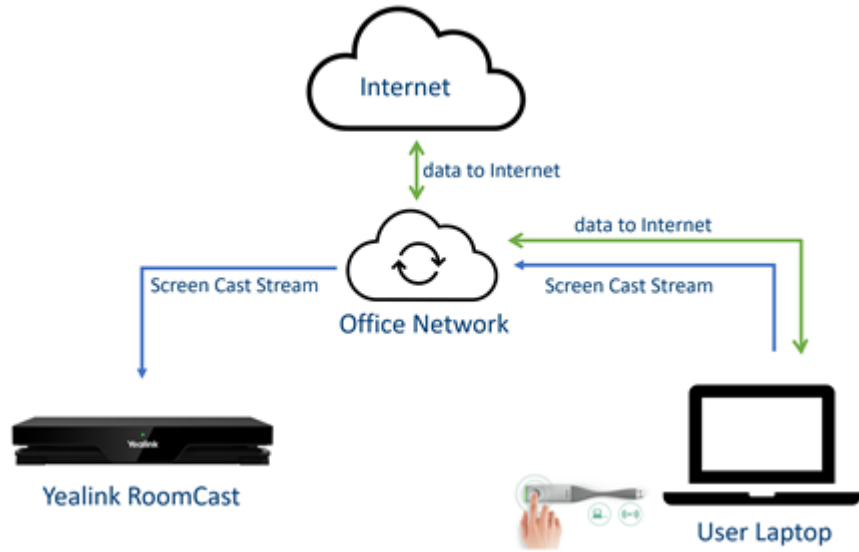

Why does the Yealink wireless screen transmitter software prompt a failure to connect to the host?

Last Update Time: 2022-11-11 Pageviews: 751

1. check that the RoomCast host is turned on as a wireless hotspot.
2. Plug the WPP20/30 into the RoomCast and re-pair it.
3. Replace the WPP20/30 or computer and try again.